

# VARIA-QUICK Stromschienenstrahler 28W 2660lm, CRI90, Digital Display Dim + CCT

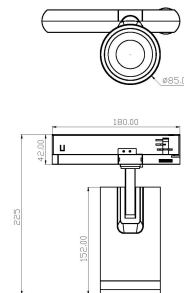

## Technical Details:

Luminous Flux:	2660 lm
Light Yield:	95 lm/W
Light Temperature:	2700-6500 K
Light Color:	dualwhite
Color Rendering Index:	≥90 Ra
Color Consistency (SDCM):	<5
Beam Angle:	50 °
Swappable Reflector:	✓
Unified Glare Rating (UGR):	<19
Light Emission:	downward
Dimmable:	✓
Method of Dimming:	PWM,Poti
LED-Chip Manufacturer:	Bridgelux
LED-Chip:	COB
Number of LED:	1
Ignition Time:	<0,5 s
Input Current:	AC 220-240V, 50/60Hz, DC 220-280V
Power Consumption:	28 W
Contains Driver:	✓
Driver Manufacturer:	Powergear
Power Factor (PF):	>0.9
Input Driver:	lighting track
Output of Driver:	DC 48V, 1000mA
Input Lamp:	Power rail

Dimensions:	225x85x180 mm
Mounting:	Decke,Wand,Stromschiene
Montageart:	surface mounted
Pivot Range pan:	355 °
Pivot Range tilt:	90 °
IP Class:	20
IK Code:	06
Housing Color	black
Housing Color (RAL Code):	similar 9005
Housing Material:	aluminum
Coating:	powder-coated
Special Feature of Housing:	for 3-Phase Track Adapter
Cover:	Lens
Net Weight:	875 g
Type of Packaging:	box
Weight incl. Packaging:	1.045 kg
Content Master Package:	12
Dimensions of Master Package:	545x405x305 mm
Weight Master Package:	13,4 kg
Product Line:	Advance Line
Warranty	3 years
Operating Hours:	60.000 h L80/B20
Disposal Obligation:	✓
Customs Tariff Number:	9405119090
Certifications	CE,LM80

Electrical Protection Class:	II
Ambient Temperature (TA):	-15°C - 40°C
Storage Temperature:	-20°C - 50°C

Blue Digital Display: CCT adjust and Dim: 1-100%
Zoom focus lens: 20-50°
CCT change: 2700-6500 Kelvin in 50K steps

Information and Downloads:

